



# **Monarch™- Multi-spectral Camera**

## **Add-On Assembly Guide**

**UNS53000**



**TABLE OF CONTENTS**

**1 PARTS LIST ..... 3**

**2 TRIPOD ADD ON ..... 4**

**3 MOBILE PHONE ADD ON ..... 5**

**4 CABLE ADD ON..... 6**

4.1 TRIPOD & CABLE ADD ONS..... 8

4.2 MOBILE PHONE & CABLE ADD ONS..... 10

# 1 Parts List

---

The MONARCH assembly kit contains the following parts:

2. Monarch Camera



3. Tripod Add On



1. M2 Screw Set

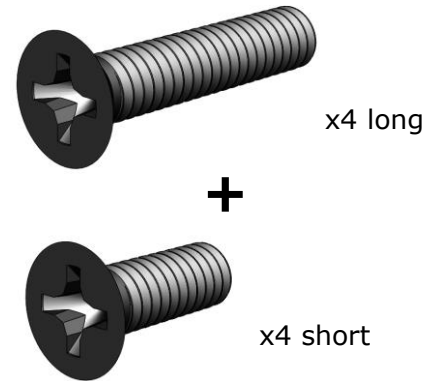

4. Cable Add On



5. Mobile Phone Add On



6. USB Cable



## 2 Tripod Add On



- Insert the 4 short screws into the designated slots in the back of the Tripod Add On

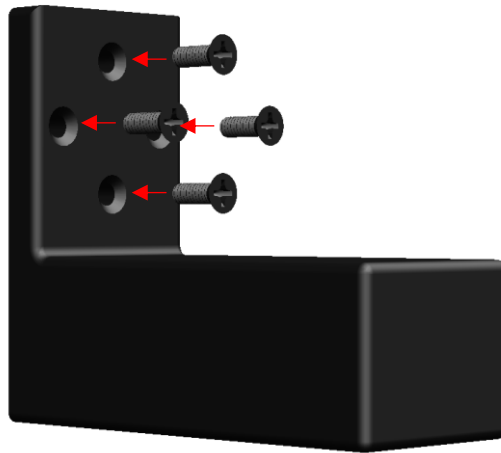

- Place the screws into the according threads in the back of the MONARCH camera and screw in tightly.



### 3 Mobile Phone Add On



- Insert the 4 short screws into the designated slots in the back of the Mobile Phone Add On.

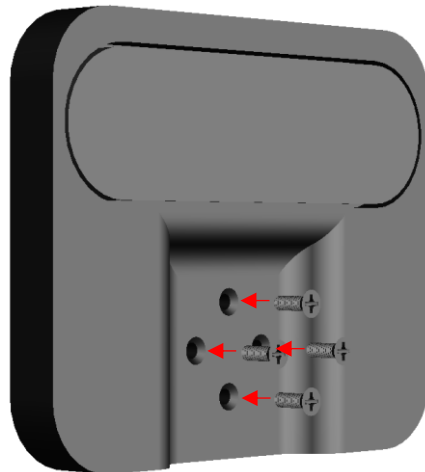

- Place the screws into the according threads in the back of the MONARCH camera and screw in tightly.



## 4 Cable Add On

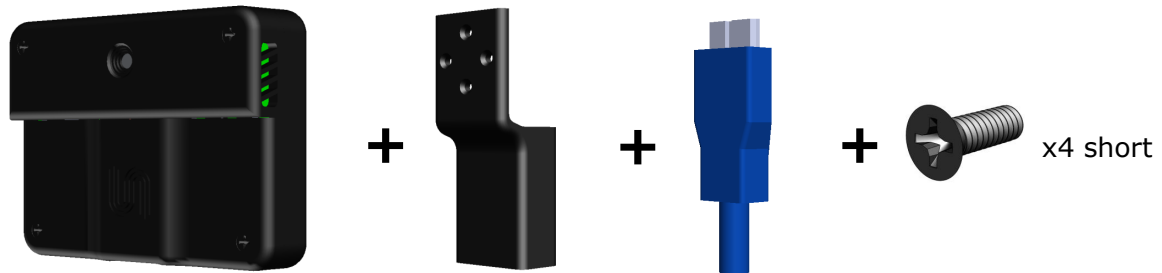

- Place the USB cable in the designated slot in the Cable Add On, flat surface of the USB plug facing up.



- Connect the USB Cable while in the add on to the MONARCH Camera.



- Insert the 4 short screws into the designated slots in the back of the Cable Add On, threading into the MONARCH Camera threads, and screw in tightly.

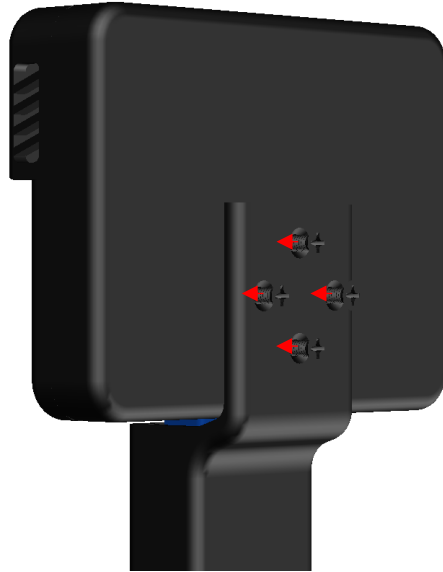

## 4.1 Tripod & Cable Add Ons

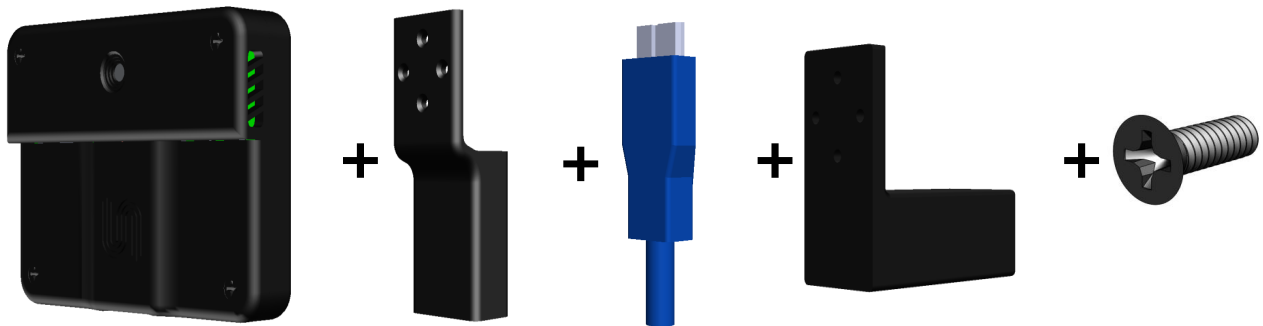

- Place the USB cable in the designated slot in the Cable Add On, flat surface of the USB plug facing up.



- Connect the USB Cable while in the add on to the MONARCH Camera.





- Place the Tripod Add On on top of the Cable Add On so the slots are aligned

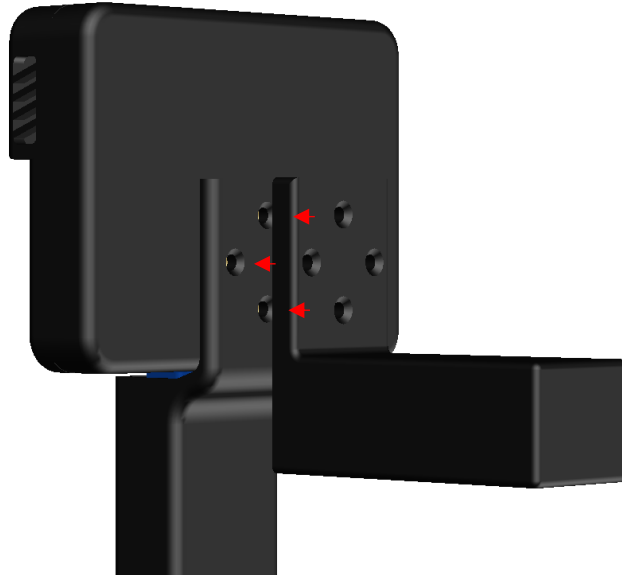

- Insert the 4 long screws into the designated slots in the back of the Cable Add On, threading into the MONARCH Camera threads, and screw in tightly.

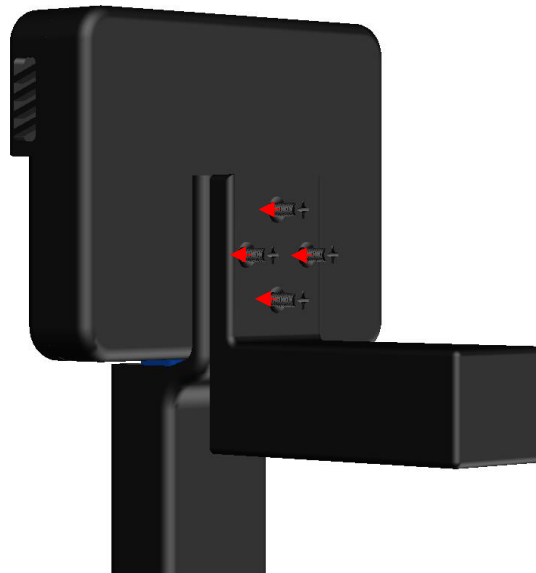

## 4.2 Mobile Phone & Cable Add Ons

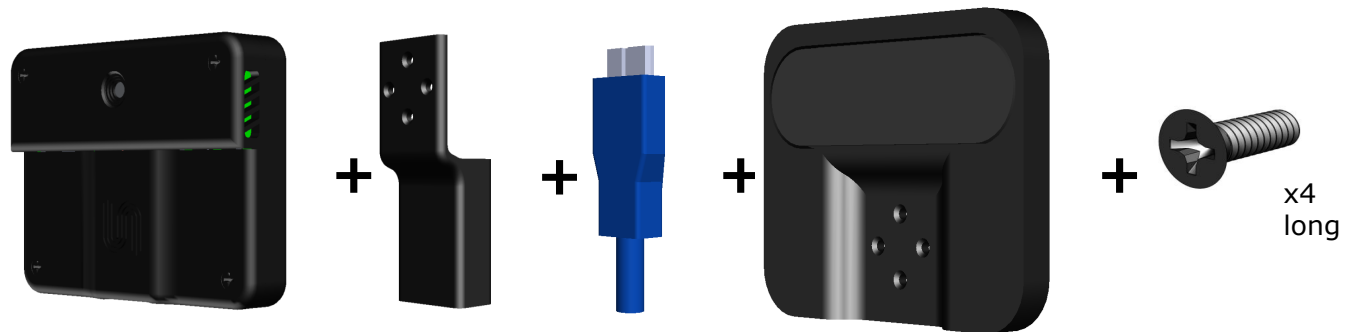

- Place the USB cable in the designated slot in the Cable Add On, flat surface of the USB plug facing up.



- Connect the USB Cable while in the add on to the MONARCH Camera.



- Place the Tripod Add On on top of the Cable Add On so the slots are aligned.



- Insert the 4 long screws into the designated slots in the back of the Cable Add On, threading into the MONARCH Camera threads, and screw in tightly.

